



CITY OF ORLANDO

MEMORANDUM

TO: David Billingsley, Chief Procurement Officer
FROM: Charlie Conklin, P.E., Project Manager
THRU: Richard M. Howard, P.E., Public Works Director
DATE: May 22, 2018

SUBJECT: Request for Negotiated Procurement of Pineloch Street Gravity Sewer

The Water Reclamation Division worked with the developer of the Southside Shoppes at Lake Pineloch to upsize their proposed lift station to serve an area south of Pineloch Street identified in a Master Plan prepared by BFA. The Master Plan requires a gravity sewer to be constructed along the south side of Pineloch Street from the lift station at Center Ave, east to Osceola Ave. Because of the physical underground limitations of where the gravity sewer can be constructed along Pineloch Street, it became apparent that the gravity sewer must be constructed at the same time as the forcemain already contracted for construction by the developer beginning next month. Since the developer already has a contractor (Prestige Paving and Land Development) working on installing the forcemain, and the two pipes must be installed together with the gravity sewer right next to and deeper than the forcemain, the only option is to have Prestige construct the gravity system for the City. Therefore, it is urgent that the City negotiate an agreement with Prestige Paving and Land Development to construct both pipelines together. The attached proposal from Prestige indicates a price of \$289,980 for the cost to construct the 10" gravity sewer system together with the forcemain. The proposed price also represents a small fraction of the cost that the City would pay to construct the gravity sewer in a separate project, because of all the other costs already being paid for by the developer to construct the forcemain.

PRESCIGE PAVING & LAND DEVELOPMENT INC.

P.O. Box 561441
Orlando, FL 32856
Phone 407-381-8181
Fax 407-381-8185

Proposal

DATE

6/7/2018

NAME / ADDRESS
City of Orlando Public Works Department 400 S. Orange Ave, 8th Floor Orlando, FL 32801

PROJECT
Pineloch Gravity Line Addition

DESCRIPTION		TOTAL
Underground - Sanitary System 1) Install one 4' x 4" wet tap. 2) Install 2" temporary poly forcemain. 3) Install 950 l.f. of 10" SDR 26. 4) Dewatering (per the duration of the project). 5) Dewatering initial installation (1000 l.f.). 6) Install one manhole 10'-12' deep. 7) Install two manholes 12' - 14' deep. 8) Install two manholes 14' deep. 9) Labor for mini lift station. 10) Temporary lift station. 11) Various fittings / link seals. 12) Install one trench box. 13) Open cut and restore Center Street. 14) Asbuilts. 15) MOT engineering fee. 16) Electrical hookup to temporary lift station. 17) Additional restoration, sod, curb, asphalt, etc. 18) Install two laterals @ Sylvan and Delaney Street. 19) Install # 57 stone. 20) Testing.		289,980.00
Original Plans Dated	Revised Plans Dated	TOTAL

Authorized Signature

Date of Acceptance

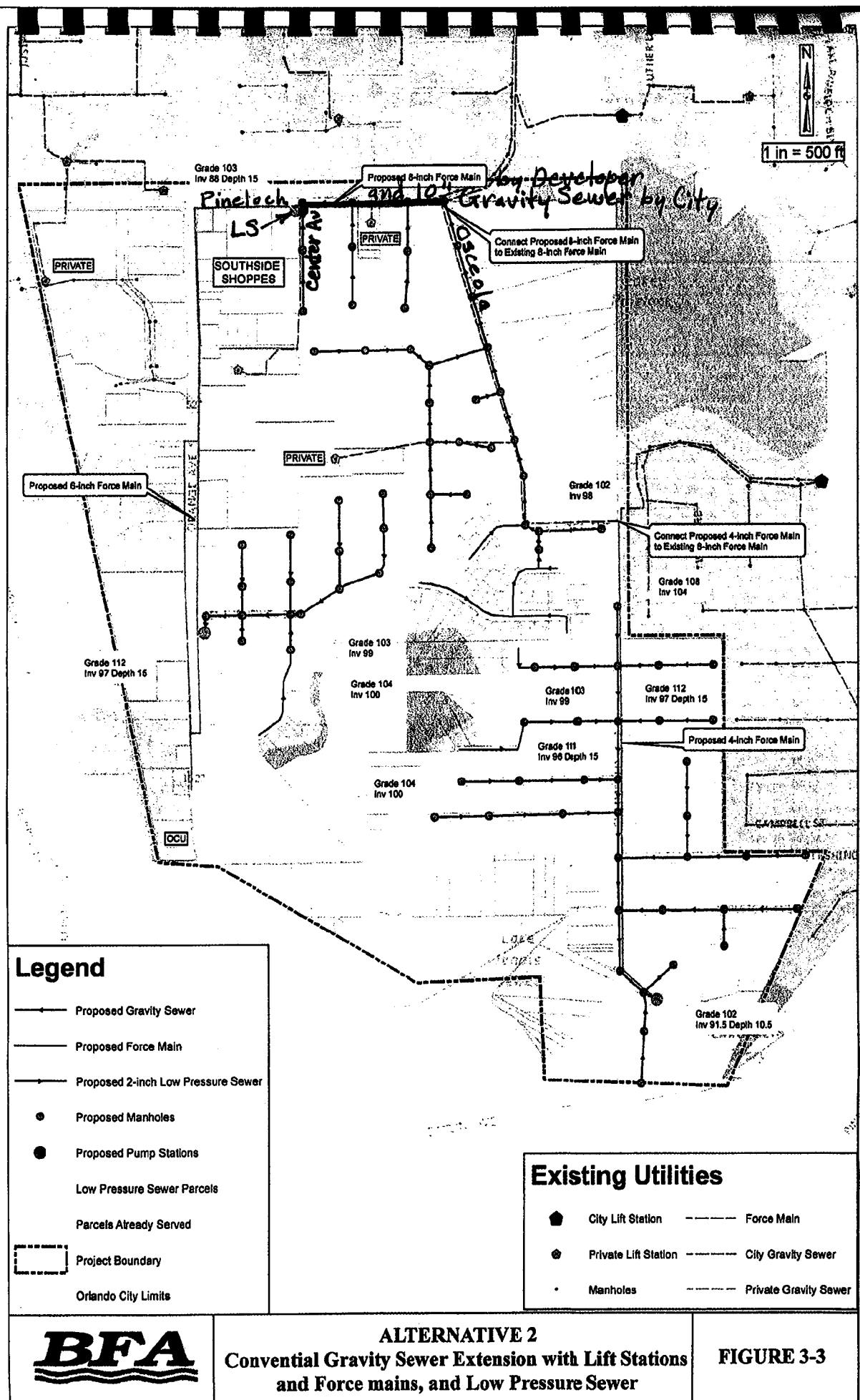

ALTERNATIVE 2
Conventional Gravity Sewer Extension with Lift Stations
and Force mains, and Low Pressure Sewer

FIGURE 3-3