

FIELDS MOTORCARS

DEDICATION

KNOW ALL BY THESE PRESENTS, That Fields Motorcars of Florida, Inc., a Florida corporation, being the owner in fee simple of the lands described in this plat, hereby dedicates said lands and plat for the uses and purposes therein expressed and dedicates said lands shown hereon to the perpetual use of the private lot owner. None of the lands depicted hereon are for public use.

IN WITNESS WHEREOF, Fields Motorcars of Florida, Inc. has executed this plat on \_\_\_\_\_, 2017.

Fields Motorcars of Florida, Inc., a Florida corporation

By: John Montague, Vice President  
Printed Name

Attest: \_\_\_\_\_

Printed Name

Signed in the presence of:

By: \_\_\_\_\_

Printed Name

By: \_\_\_\_\_

Printed Name

STATE OF \_\_\_\_\_ COUNTY OF \_\_\_\_\_, 2017, before me, \_\_\_\_\_, Notary Public, do hereby certify that on \_\_\_\_\_, 2017, before me, \_\_\_\_\_, a duly authorized officer duly authorized to take acknowledgments in the State and County aforesaid, personally appeared David Shapiro of the above named Limited Liability Company incorporated under the laws of Florida who is/are personally known to me or have produced the following identification \_\_\_\_\_ and who executed the foregoing dedication and severally acknowledged the execution thereof to be their free act and deed as such officers thereto duly authorized and that said dedication is the act and deed of said Corporation.

IN WITNESS WHEREOF, I have hereto set my hand and seal on the above date.

NOTARY PUBLIC \_\_\_\_\_  
My Commission Expires \_\_\_\_\_

CERTIFICATE OF APPROVAL BY MUNICIPALITY

THIS IS TO CERTIFY, That on the \_\_\_\_\_ approved the foregoing plat.

MAYOR PROTEM \_\_\_\_\_ City Clerk

ATTEST: \_\_\_\_\_

CERTIFICATE OF APPROVAL BY CITY PLANNING OFFICIAL

Examined and Approved: \_\_\_\_\_

Date: \_\_\_\_\_

City Planning Official: \_\_\_\_\_

CERTIFICATE OF APPROVAL BY CITY ENGINEER

Examined and Approved: \_\_\_\_\_

Date: \_\_\_\_\_

City Engineer: \_\_\_\_\_

CERTIFICATE OF REVIEW BY CITY SURVEYOR

Reviewed for conformity to Florida State Statute 177

City Surveyor: \_\_\_\_\_

Date: \_\_\_\_\_

CERTIFICATE OF COUNTY COMPTROLLER

I HEREBY CERTIFY that the foregoing plat was recorded in the Orange County Official Records on \_\_\_\_\_ as File No. \_\_\_\_\_

County Comptroller In and for Orange County, Florida

By \_\_\_\_\_

QUALIFICATION STATEMENT OF SURVEYOR AND MAPPER

KNOW ALL BY THESE PRESENTS, That undersigned, being a professional surveyor and mapper that has prepared the foregoing plat and was made under my direction and supervision and that the plat complies with all of the survey requirements of Chapter 177, Florida Statutes; and that said land is located in the City of Orlando, Orange County, Florida.

Dated: \_\_\_\_\_ Signed: \_\_\_\_\_  
Registration Number LS 6552 FAUN M. HOFFMEIER

H & H SURVEY CONSULTANTS, LLC  
131 W BROADWAY ST., SUITE B  
OWIEDO, FLORIDA 32765

FIELDS MOTORCARS

A PORTION OF THE NORTHWEST 1/4 OF

SECTION 10, TOWNSHIP 23 SOUTH, RANGE 29 EAST,

CITY OF ORLANDO, ORANGE COUNTY, FLORIDA

LEGAL DESCRIPTION : A portion of the Northwest 1/4 of Section 10, Township 23 South, Range 29 East, Orange County, Florida, more particularly described as follows:

Commence at the Northeast corner of the Northwest 1/4 of Section 10, Township 23 South, Range 29 East, run N 89°49'12" W along the North line of the Northwest 1/4 of Section 10, a distance of 1669.60 feet; thence departing said North line, run S 00°04'13" E a distance of 50.00 feet to a point on the South right-of-way line of 33rd Street, said point also being the Point of Beginning; thence departing said right-of-way line, continue S 00°04'13" E a distance of 400.00 feet; thence N 89°49'12" W a distance of 27.49 feet; thence S 00°04'13" E a distance of 365.58 feet; thence S 89°54'12" W a distance of 954.65 feet; thence N 00°01'58" E a distance of 40.06 feet; thence N 30°35'08" E a distance of 603.67 feet; thence S 59°24'52" E a distance of 108.48 feet; thence S 89°59'06" E a distance of 220.95 feet; thence N 00°04'13" W a distance of 263.72 feet to a point on the aforementioned South right-of-way line; thence S 89°49'12" E along said right-of-way line, a distance of 360.00 feet to the Point of Beginning.

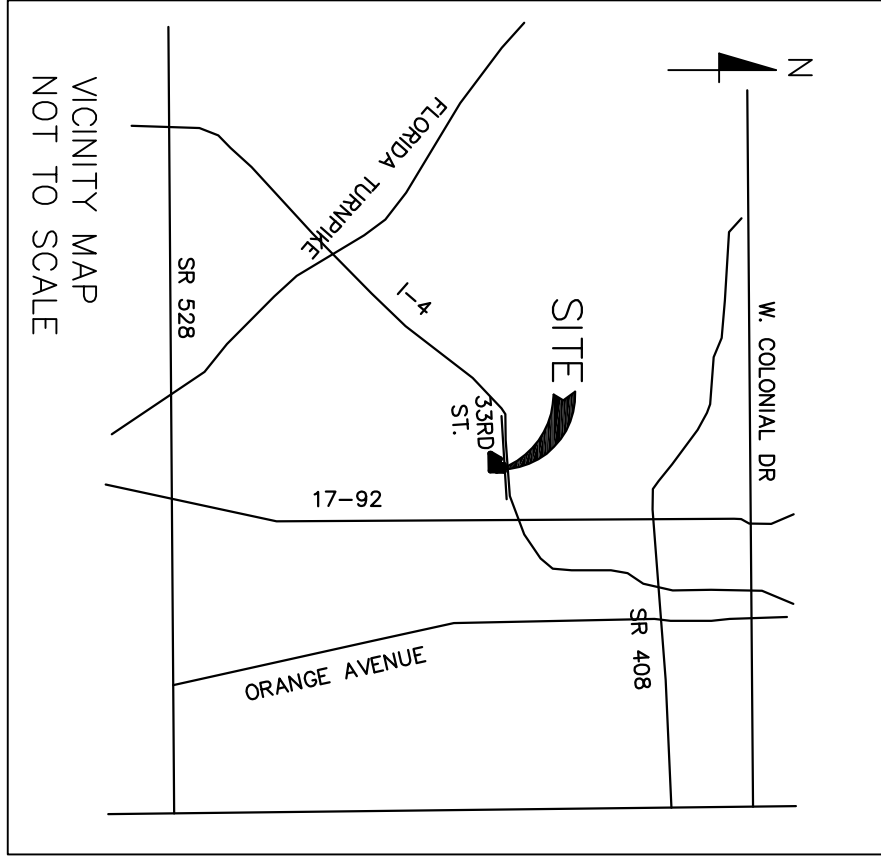

NOTES:

1. BASIS OF BEARING – THE SOUTHERLY RIGHT OF WAY LINE OF 33rd STREET, AS BEING S 89°49'12" E, PER DEED.
2. ALL PLATTED UTILITY EASEMENTS SHALL PROVIDE THAT SUCH EASEMENTS SHALL ALSO PROVIDE FOR THE INSTALLATION, MAINTENANCE, AND OPERATION OF CABLE TELEVISION SERVICES; PROVIDED, HOWEVER, NO SUCH CONSTRUCTION, INSTALLATION, MAINTENANCE, AND OPERATION OF CABLE TELEVISION SERVICES SHALL INTERFERE WITH THE FACILITIES AND SERVICES OF AN ELECTRIC, TELEPHONE, GAS, OR OTHER PUBLIC UTILITY. IN THE EVENT A CABLE TELEVISION COMPANY DAMAGES THE FACILITIES OF A PUBLIC UTILITY, IT SHALL BE SOLELY RESPONSIBLE FOR THE DAMAGES INCURRED ON THIS PROPERTY. DEPICTED ON THIS PLAT IS SUBJECT TO THE REQUIREMENTS OF CHAPTER 39, THE CONCURRENTLY MANAGEMENT ORDINANCE OF THE CITY OF ORLANDO, WHICH GOVERNS THE CITY'S ABILITY TO ISSUE BUILDING PERMITS ON THIS PROPERTY. APPROVAL OF THIS PLAT SHALL NOT BE DEEMED TO PROVIDE ANY VESTED RIGHTS, EXCEPT AS TO THOSE MATTERS DEPICTED HEREON, THAT ARE CONSISTENT WITH THE REQUIREMENTS OF CHAPTER 177, FLORIDA STATUTES, OR WERE REQUIRED BY THE CITY OF ORLANDO AS A CONDITION OF PLATTING.
- 3.

LEGEND & ABBREVIATIONS

- FIR = FOUND IRON ROD
- FND = FOUND
- N/D = NAIL & DISK
- SIR = SET IRON ROD
- CMON = CONCRETE MONUMENT
- PSM = PROFESSIONAL SURVEYOR & MAPPER
- ESM/T = EASEMENT
- OR = OFFICIAL RECORDS (BOOK)
- LB = LICENSED BUSINESS
- PG = PLAT BOOK
- R/W = RIGHT OF WAY
- (D) = DEED DIMENSION
- (M) = FIELD MEASURED
- ☐ = 4" CMON "PRM LB 7821"
- ☐ (UNLESS OTHERWISE NOTED)
- ☐ = FND 5/8" IRON ROD
- ☒ = FND N/D

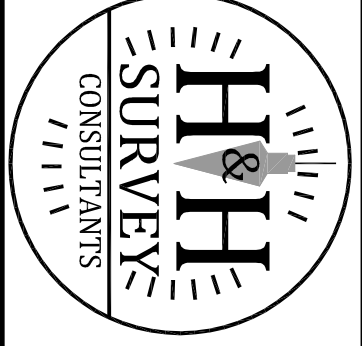

H & H SURVEY CONSULTANTS, LLC

LB 7821  
131 W BROADWAY ST., SUITE B  
OWIEDO, FL 32765  
407-542-4977

NOTICE: THIS PLAT, AS RECORDED IN ITS GRAPHIC FORM, IS THE OFFICIAL DEPICTION OF THE SUBDIVIDED LANDS DESCRIBED HEREIN AND WILL IN NO CIRCUMSTANCES BE SUPPLANTED IN AUTHORITY BY ANY OTHER GRAPHIC OR DIGITAL FORM OF THE PLAT. THERE MAY BE ADDITIONAL RESTRICTIONS THAT ARE NOT RECORDED ON THIS PLAT THAT MAY BE FOUND IN THE PUBLIC RECORDS OF THIS COUNTY.