

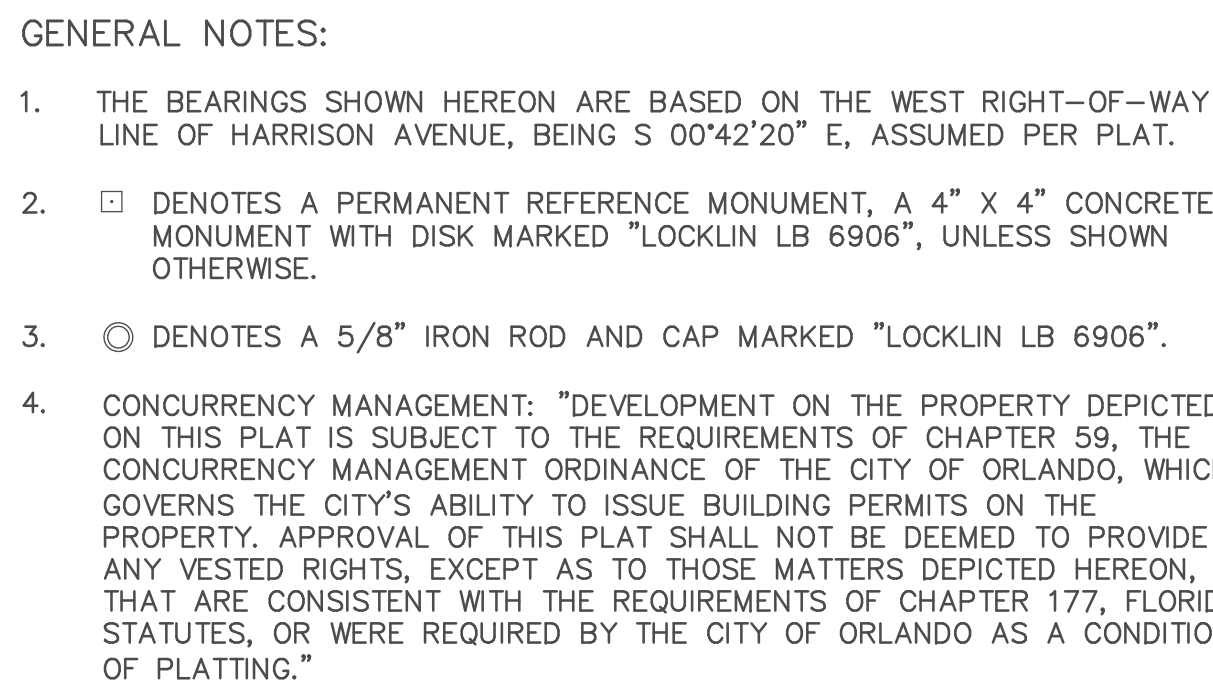

BEGINNING AT THE NORTHEAST CORNER OF SAID LOT 7, BLOCK F, THENCE S00°42'20"E, ALONG THE EAST LINE OF SAID LOTS 7 AND 8, BLOCK F, A DISTANCE OF 99.93 FEET TO THE SOUTHEAST CORNER OF SAID LOT 8; THENCE S89°34'37"W, ALONG THE SOUTH LINE OF SAID LOT 8, A DISTANCE OF 139.89 FEET TO THE SOUTHWEST CORNER OF SAID LOT 8; THENCE N00°39'21"W, ALONG THE WEST LINE OF SAID LOTS 7 AND 8, A DISTANCE OF 100.28 FEET TO THE NORTHWEST CORNER OF SAID LOT 7; THENCE N89°43'14"E, ALONG THE NORTH LINE OF SAID LOT 7, A DISTANCE OF 139.76 FEET TO THE POINT OF BEGINNING.

GRAPHIC SCALE

(IN FEET)
1 inch = 20 ft.

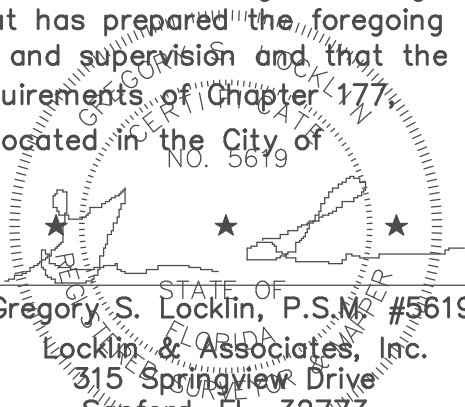

 **LOCKLIN & ASSOCIATES, INC.**
SURVEYORS & MAPPERS
Land Surveyor Business No. 6906
315 Springview Drive
Sanford, FL 32773
(407) 302-4001

PLAT BOOK		PAGE	
<h2>DUBSDREAD VIEW (A REPLAT) DEDICATION</h2>			
KNOW ALL MEN BY THESE PRESENTS, That the undersigned, being the being the owner in fee simple of the lands described in the foregoing caption to this plat, hereby dedicates said lands and plat for the uses and purposes therein expressed.			
IN WITNESS WHEREOF, The undersigned have hereunto set their hands on this _____ day of _____, 2005			
OWNERS: _____ <div>RACHEL COOPER</div>		_____ <div>SAMUEL H. MAXWELL, JR.</div>	
OWNERS: _____ <div>CHERYL L. MURPHY</div>			
Signed in the presence of:			
Printed Name _____		_____	
Printed Name _____		_____	
STATE OF FLORIDA, COUNTY OF ORANGE			
THIS IS TO CERTIFY, That on this _____ day of _____, 2005, before me, an officer duly authorized to take acknowledgements in the State and County aforesaid, personally appeared Rachel Cooper, Samuel H. Maxwell, Jr. and Cheryl L. Murphy personally known to me or produced the following identification: _____, and did (did not) take an oath that they are the persons described in and who executed the foregoing dedication and severally acknowledged the execution thereof to be their free act and deed for the uses and purposes therein expressed.			
IN WITNESS WHEREOF, I have hereto set my hand and seal on the above date.			
NOTARY PUBLIC _____ My commission expires _____			
QUALIFICATION STATEMENT OF SURVEYOR AND MAPPER			
KNOW ALL MEN BY THESE PRESENTS, That the undersigned, being a professional surveyor and mapper that has prepared the foregoing plat and was made under my direction and supervision and that the plat complies with all of the survey requirements of Chapter 177, Florida Statutes; and that said land is located in the City of Orlando, Orange County, Florida. <div style="text-align: right; margin-top: -50px;"></div>			
Dated: 10/14/16		Signed _____ Gregory S. Locklin, P.S.M. #3619 Locklin & Associates, Inc. 315 Springview Drive Sanford, FL 32773	
CERTIFICATE OF APPROVAL BY MUNICIPALITY			
THIS IS TO CERTIFY, That on _____ the _____, approved the foregoing plat.			
ATTEST: MAYOR PRO TEM _____ CITY CLERK _____			
CERTIFICATE OF APPROVAL BY CITY PLANNING AND DEVELOPMENT DIRECTOR			
Examined and Approved: _____ Date _____ City Planning Official _____			
CERTIFICATE OF APPROVAL BY CITY ENGINEER			
Examined and Approved: _____ Date _____ City Engineer _____			
CERTIFICATE OF REVIEW BY CITY SURVEYOR			
Reviewed for conformity to Florida State Statute 177 City Surveyor _____ Date _____			
CERTIFICATE OF COUNTY COMPTROLLER			
I HEREBY CERTIFY That the foregoing plat was recorded in Orange County Official Records on _____ as File No. _____ County Comptroller in and for Orange County, Florida. By: _____			