

ORLANDO CITY SOCCER STADIUM

SHEET 1 OF 2

A REPLAT OF H.J. PATRICK'S SUB-DIVISION, PLAT BOOK "F", PAGE 45 AND SELLERS CENTRAL AVENUE SUB-DIVISION, PLAT BOOK "G", PAGE 88 AND A PORTION OF DREW AND PHILLIPS SUB-DIVISION, PLAT BOOK "D", PAGE 128 AND A PORTION OF PARRAMORE HERITAGE PARK, PLAT BOOK 62, PAGE 47  
BEING A PORTION OF SECTION 26, TOWNSHIP 22 SOUTH, RANGE 29 EAST  
CITY OF ORLANDO, ORANGE COUNTY, FLORIDA

DESCRIPTION:

A portion of the south 1/2 of the southwest 1/4 of Section 26, Township 22 South, Range 29 East, City of Orlando, Orange County, Florida; Lot 1, Lot 2, Lot 3, Lot 4 of Sellers Central Avenue Sub-Division as recorded in Plat Book G, Page 88; Lot 1, Lot 2, Lot 3, Lot 4, Lot 5 of H.J. Patrick's Sub-Division as recorded in Plat Book F, Page 45; all of Lot 7, Lot 8, Lot 20, Lot 21, Lot 22, Lot 23 together with a portion of Lot 6 and Lot 9 and the Vacated Pine Street Right of Way West of Lot 19 of Drew and Phillips Sub-Division as recorded in Plat Book D, Page 128; Lot 1, Lot 2, Lot 3, of Block A, Parramore Heritage Park as recorded in Plat Book 62, Page 46; and the Vacated Parramore Right of Way North of West Church Street and South of West Central Boulevard.

Being More Particularly described as follows,

BEGIN at the Northwest corner of Lot 1 Sellers Central Avenue Sub-Division as recorded in Plat Book G, Page 88 , thence run along the South Right of Way line of West Central Avenue North 89° 51' 59" East a distance of 266.70 feet; thence departing said South Right of Way line run South 00° 24' 46" East a distance of 335.71 feet to the Northeast corner of Lot 20 of said Drew and Phillips Sub-Division; thence run along the East line of Lot 20 and Lot 23 of said Drew and Phillips Sub-Division South 00° 24' 46" East a distance of 276.07 feet to the Southeast corner of said Lot 23 and the North Right of Way line of West Church Street; thence run along said North Right of Way line South 89° 43' 48" West a distance of 259.77 feet; thence along said North Right of Way line North 88° 02' 19" West a distance of 84.02 feet to the Southermost East corner of Lot 2 Parramore Heritage Park as recorded in Plat Book 62, Page 46; thence along said North Right of Way line of West Church Street South 89°38' 19" West a distance of 408.40 feet to the Southwest corner of Lot 1 of said Parramore Heritage Park and the East Right of Way of Glenn Lane; thence along the West line of said Lot 1 and said East Right of Way North 00°14' 27" West a distance of 613.05 feet to the Northwest corner of said Lot 1 and the South Right of Way line of West Central Avenue; thence along the said South Right of Way line North 89° 56' 22" East a distance of 424.43 feet to the Northeast corner of Lot 3 of said Parramore Heritage Park; thence along said South Right of Way line South 88° 37' 31" East a distance of 59.18 feet to the POINT OF BEGINNING.

Containing 459,726 square feet or 10.554 acres (more or less)

SURVEYOR'S NOTES:

1.

Bearings are based on the South right of way line of West Central Boulevard being North 89°51'59" East, as derived from the Florida State Plane Coordinate System, East Zone, NAD 83(2007).
2.

Development on this property depicted on this plat is subject to the requirements of Chapter 59, the Concurency Management Ordinance of the City of Orlando, which governs the city's ability to issue building permits on this property. approval of this plat shall not be deemed to provide any vested rights, except as to those matters depicted hereon, that are consistent with the requirements of Chapter 177, Florida Statutes, or were required by the City of Orlando as a condition of platting.

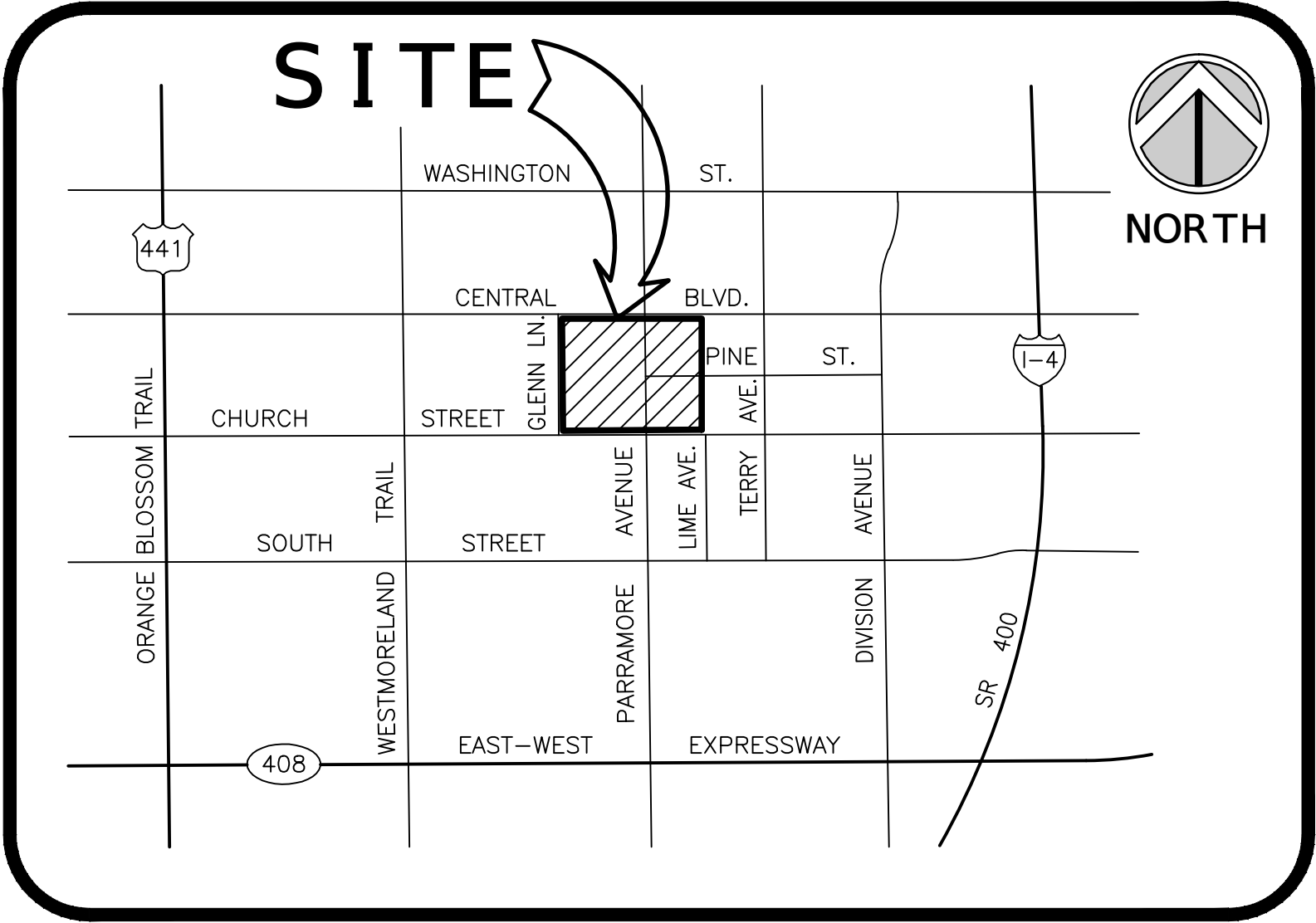

VICINITY MAP:  
NOT TO SCALE

LEGEND/ABBREVIATIONS:

- SET 4"x4" CONCRETE MONUMENT W/DISC "WBQ--PRM" LB#7963
- △

SET NAIL & DISC "WBQ--PRM" LB#7963
- R/W

RIGHT OF WAY
- CCR

CERTIFIED CORNER RECORD
- P.B.

PLAT BOOK
- PG.

PAGE
- O.R.B.

OFFICIAL RECORDS BOOK
- FND.

FOUND
- N&D

NAIL AND DISC
- FDOT

FLORIDA DEPARTMENT OF TRANSPORTATION
- LB

LICENSED BUSINESS

NOTICE: THIS PLAT, AS RECORDED IN ITS GRAPHIC FORM, IS THE OFFICIAL DEPICTION OF THE SUBDIVIDED LANDS DESCRIBED HEREIN AND WILL IN NO CIRCUMSTANCES BY SUPPLANTED IN AUTHORITY BY ANY OTHER GRAPHIC OR DIGITAL FORM OF THE PLAT. THERE MAY BE ADDITIONAL RESTRICTIONS THAT ARE NOT RECORDED ON THIS PLAT THAT MAY BE FOUND IN THE PUBLIC RECORDS OF THIS COUNTY.

PLAT BOOK:

PAGE:

ORLANDO CITY SOCCER STADIUM  
DEDICATION

KNOW ALL MEN BY THESE PRESENTS, That the City of Orlando, a municipal corporation under the laws of Florida, being the owner in fee simple of the lands described in the foregoing caption to this plat, hereby dedicates said lands and plat for the uses and purposes therein expressed.

IN WITNESS WHEREOF, has caused these presents to be signed by the official named below and its Municipal Corporate seal affixed hereto on

-----  
(date)

CITY OF ORLANDO, a municipal corporation duly created and existing under and by virtue of the laws of the State of Florida

By:-----  
Printed name

Mayor / Mayor Pro Tem

SIGNED AND SEALED IN PRESENCE OF:

-----  
Printed name

-----  
Signature

-----  
Printed name

-----  
Signature

STATE OF FLORIDA COUNTY OF ORANGE

THIS IS TO CERTIFY, That on \_\_\_\_\_ before me, an officer duly authorized to take acknowledgments in the State and County aforesaid, personally appeared

Mayor/Mayor Pro Tem of the above named municipal corporation incorporated under the laws of Florida described in and who executed the foregoing dedication and severally acknowledged the execution thereof to be his/her free act and deed as such officer thereunto duly authorized; that the official seal of said municipal corporation affixed hereto; and that the said dedication is the act and deed of said municipal corporation. He/She (check one) \_\_\_\_\_ is personally known to me or \_\_\_\_\_ has produced \_\_\_\_\_ as identification.

IN WITNESS WHEREOF, I have hereunto set my hand and seal on the above date.

\_\_\_\_\_  
NOTARY PUBLIC  
(Print Name) \_\_\_\_\_  
My Commission Expires \_\_\_\_\_

QUALIFICATION STATEMENT OF  
SURVEYOR AND MAPPER

KNOW ALL MEN BY THESE PRESENTS, That the undersigned, being a professional surveyor and mapper that has prepared the foregoing plat and was made under my direction and supervision and that the plat complies with all of the survey requirements if Chapter 177, Florida Statues; and that said land is located in the City of Orlando, Orange County, Florida.

Dated: \_\_\_\_\_  
Registration Number: 6227

Signed: \_\_\_\_\_  
Herman Daniel Williams III, P.S.M.  
WBQ Design & Engineering, Inc.  
201 N. Magnolia Avenue, Suite 200  
Orlando, Florida 32801  
Licensed Business Number 7963

CERTIFICATE OF APPROVAL BY MUNICIPALITY

THIS IS TO CERTIFY, That on \_\_\_\_\_, the ORLANDO CITY COUNCIL approved the foregoing plat.

\_\_\_\_\_  
MAYOR PRO TEM

ATTEST: \_\_\_\_\_  
CITY CLERK

CERTIFICATE OF APPROVAL BY  
CITY PLANNING OFFICIAL

Examined and Approved: \_\_\_\_\_  
City Planning Official Date

CERTIFICATE OF APPROVAL BY CITY ENGINEER

Examined and Approved: \_\_\_\_\_  
City Engineer Date

CERTIFICATE OF REVIEW BY CITY SURVEYOR

Reviewed for conformity to Florida State Statute 177

\_\_\_\_\_  
City Surveyor Date

CERTIFICATE OF COUNTY COMPTROLLER

I HEREBY CERTIFY, That the foregoing plat was recorded in the Orange County Official Records on \_\_\_\_\_ as File No. \_\_\_\_\_

County Comptroller in and for Orange County, Florida

BY: \_\_\_\_\_

# ORLANDO CITY SOCCER STADIUM

SHEET 2 OF 2

PLAT  
BOOK:

PAGE:

A REPLAT OF H.J. PATRICK'S SUB-DIVISION, PLAT BOOK "F", PAGE 45 AND SELLERS CENTRAL AVENUE SUB-DIVISION, PLAT BOOK "G", PAGE 88 AND A PORTION OF DREW AND PHILLIPS SUB-DIVISION, PLAT BOOK "D", PAGE 128 AND A PORTION OF PARRAMORE HERITAGE PARK, PLAT BOOK 62, PAGE 47  
BEING A PORTION OF SECTION 26, TOWNSHIP 22 SOUTH, RANGE 29 EAST  
CITY OF ORLANDO, ORANGE COUNTY, FLORIDA

GRAPHIC SCALE

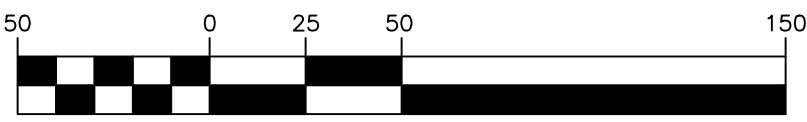

( IN FEET )  
1 inch = 50 ft.

