



VERIFIED LEGAL DESCRIPTION FORM

(APPENDIX C)

EXHIBIT

A

The following legal description has been prepared by

Jeffrey D. Hofius

and submitted to the City Planning Bureau for verification.

Signature

[Signature]

Date

11/16/2015

"This description has been reviewed by the Bureau of Engineering and is acceptable based on a comparison with:

LEADING EDGE SURVEY
OF 10-21-14, RAN

TRAVELER CLOSURE.

By

[Signature]

Date

1-13-2016

Application Request (Office Use Only)

File No. ANX2015-00029

Legal Description Including Acreage (To be typed by Applicant):

A PARCEL OF LAND LOCATED IN THE NW 1/4 OF SECTION 20, TOWNSHIP 24 SOUTH, RANGE 31 EAST, ORANGE COUNTY, FLORIDA, BEING MORE PARTICULARLY DESCRIBED AS FOLLOWS:

COMMENCE AT THE WEST 1/4 CORNER OF SAID SECTION 20; THENCE WITH THE SOUTH LINE OF THE NW 1/4 OF SAID SECTION 20, S89°48'41"E, A DISTANCE OF 33.00 FEET TO THE EAST RIGHT-OF-WAY LINE OF NARCOOSSEE ROAD (VARIABLE-WIDTH RIGHT OF WAY) AND THE POINT OF BEGINNING;

THENCE WITH SAID EAST RIGHT-OF-WAY LINE THE FOLLOWING SIX (6) COURSES: 1) N00°56'16"E, A DISTANCE OF 1132.58 FEET; 2) N01°13'54"E, A DISTANCE OF 195.06 FEET; 3) N00°06'28"E, A DISTANCE OF 34.51 FEET; 4) N00°56'16"E, A DISTANCE OF 25.30 FEET; 5) N01°14'31"E, A DISTANCE OF 94.22 FEET; 6) N00°11'07"W, A DISTANCE OF 1.75 FEET; THENCE LEAVING SAID EAST RIGHT-OF-WAY LINE, N89°54'50"E, A DISTANCE OF 1288.31 FEET TO THE EAST LINE OF THE NW 1/4 OF THE NW 1/4 OF SAID SECTION 20; THENCE WITH SAID EAST LINE, S00°41'52"W, A DISTANCE OF 165.50 FEET TO THE NORTHWEST CORNER OF THE SE 1/4 OF THE NW 1/4 OF SAID SECTION 20; THENCE WITH THE NORTH LINE OF THE W 1/4 OF THE SE 1/4 OF THE NW 1/4 OF SAID SECTION 20, N89°56'40"E, A DISTANCE OF 330.74 FEET TO THE NORTHEAST CORNER OF THE W 1/4 OF THE SE 1/4 OF THE NW 1/4 OF SAID SECTION 20; THENCE WITH THE EAST LINE OF THE W 1/4 OF THE SE 1/4 OF THE NW 1/4 OF SAID SECTION 20, S00°38'17"W, A DISTANCE OF 1325.41 FEET TO THE SE CORNER OF THE W 1/4 OF THE SE 1/4 OF THE NW 1/4 OF SAID SECTION 20; THENCE WITH THE SOUTH LINE OF THE NW 1/4 OF SAID SECTION 20, N89°48'41"W, A DISTANCE OF 1627.53 FEET TO THE POINT OF BEGINNING.

CONTAINING 54.1701 ACRES OF LAND, MORE OR LESS.

1 OF 1

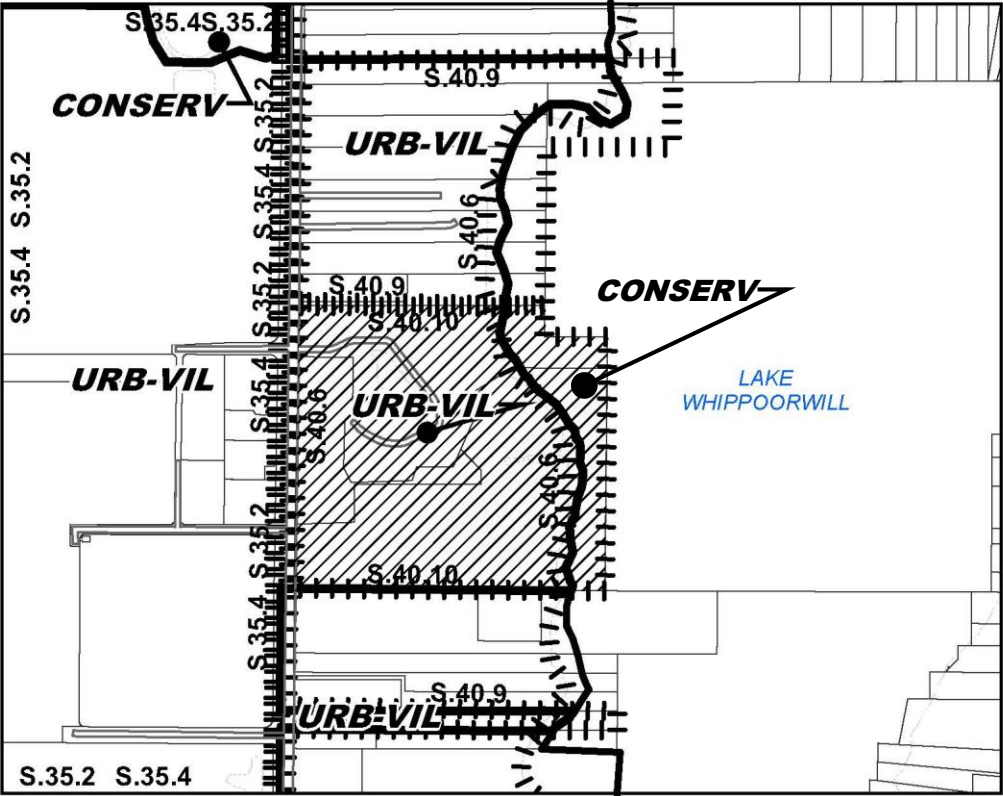

Future Land Use - Proposed GMP2015-00052

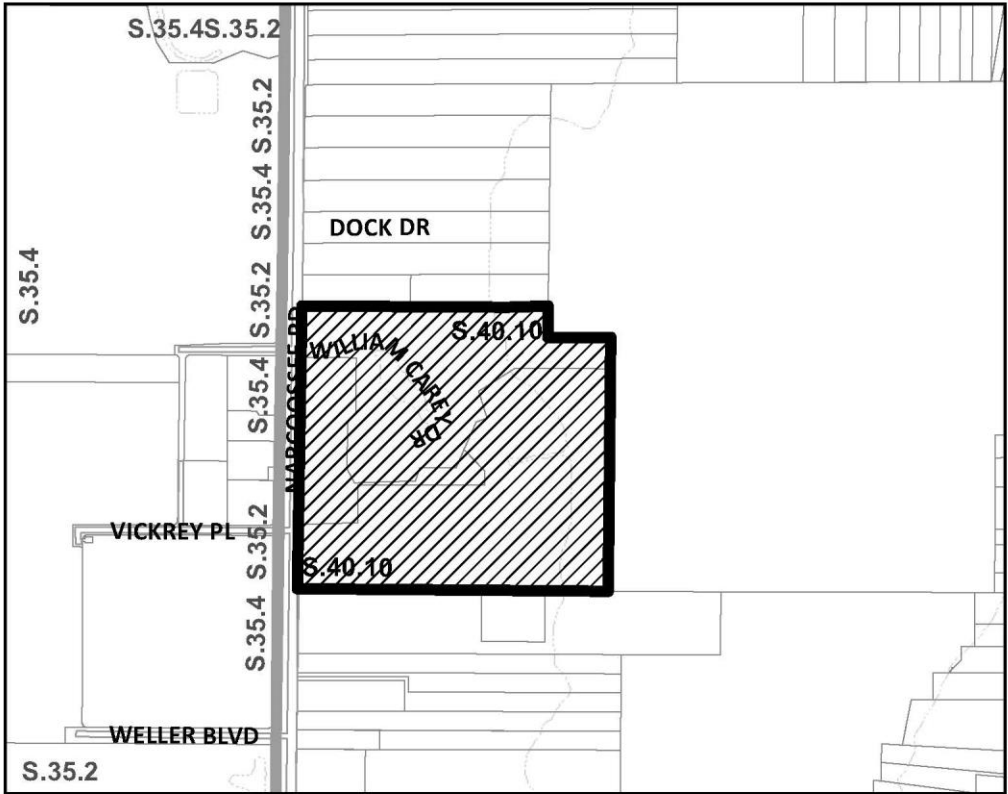

Future Land Use - Proposed GMP2015-00053

