



# VERIFIED LEGAL DESCRIPTION FORM

(APPENDIX C)



The following legal description has been prepared by

Tinklepaugh Surveying Services / Tom Heinrich

and submitted to the City Planning Bureau for verification.

[Signature]  
Signature

Sept 25 2015

Date

"This description has been reviewed by the Bureau of Engineering and is acceptable based on a comparison with:

THE RECORD PLAT,  
TINKLEPAUGH SURVEY OF  
8/20/15, RAN TRAV & CLOSE.

By [Signature] Date 10-6-2015

Application Request (Office Use Only)

File No.

ANX2015-00024  
GMP2015-00045  
ZON2015-00040

Legal Description Including Acreage (To be typed by Applicant):

## LEGAL DESCRIPTION

LOT 2, KASPER COURT, ACCORDING TO THE PLAT THEREOF, AS RECORDED IN PLAT BOOK "T", PAGE 54, OF THE PUBLIC RECORDS OF ORANGE COUNTY, FLORIDA, BEING MORE PARTICULARLY DESCRIBED AS FOLLOWS:

BEGIN AT THE NORTHWEST CORNER OF SAID LOT 2, KASPER COURT; THENCE NORTH 89°39'59" EAST, ALONG THE NORTH LINE OF SAID LOT 2, FOR A DISTANCE OF 114.01 FEET TO THE NORTHEAST CORNER OF SAID LOT 2; THENCE SOUTH 00°14'18" WEST, ALONG THE EAST LINE OF SAID LOT 2, FOR A DISTANCE OF 59.00 FEET TO THE SOUTHEAST CORNER OF SAID LOT 2; THENCE SOUTH 89°39'59" WEST, ALONG THE SOUTH LINE OF SAID LOT 2, FOR A DISTANCE OF 114.01 FEET TO THE SOUTHWEST CORNER OF SAID LOT 2; THENCE NORTH 00°14'18" EAST, ALONG THE WEST LINE OF SAID LOT 2 AND THE EASTERLY RIGHT OF WAY LINE OF FERN CREEK AVENUE, FOR A DISTANCE OF 59.00 FEET TO THE POINT OF BEGINNING. CONTAINS 0.154 ACRES, MORE OR LESS.

1 of 1

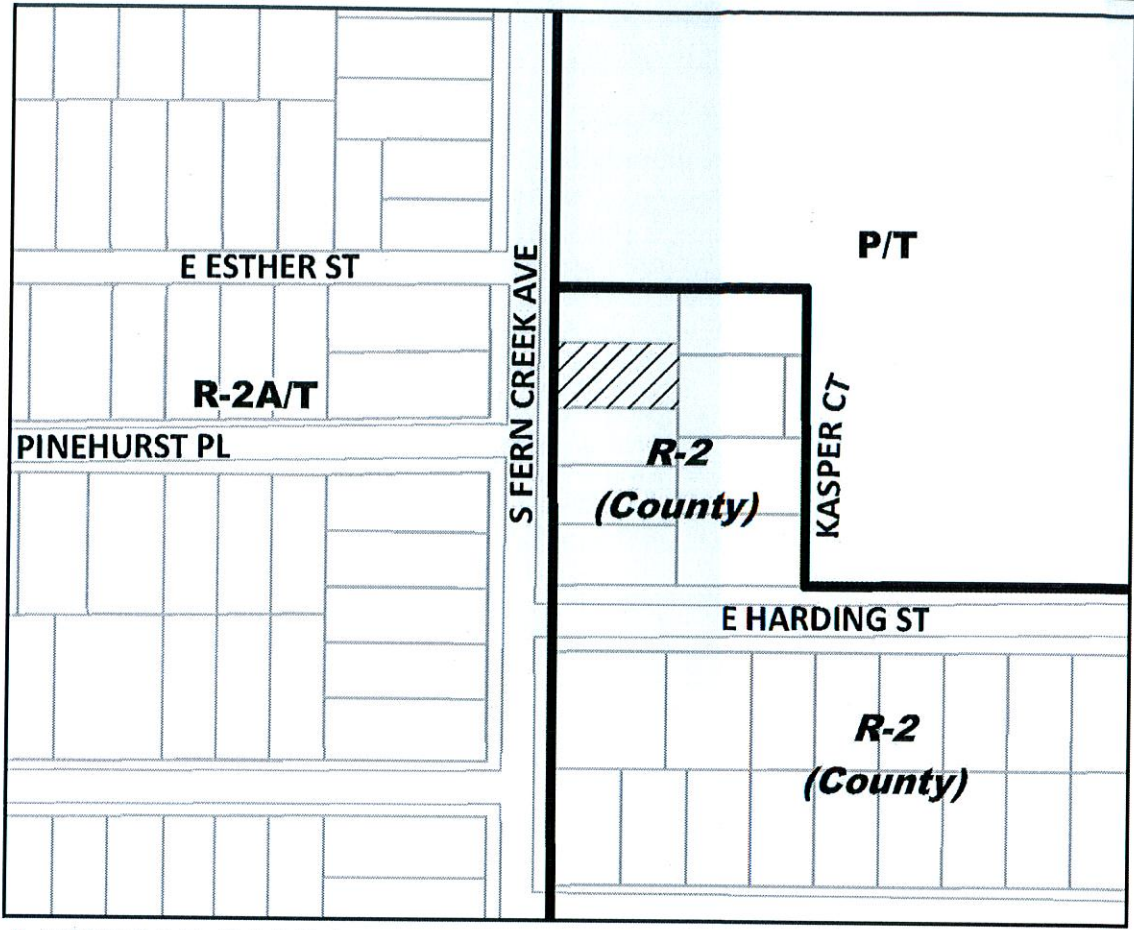

ANX2015-00024





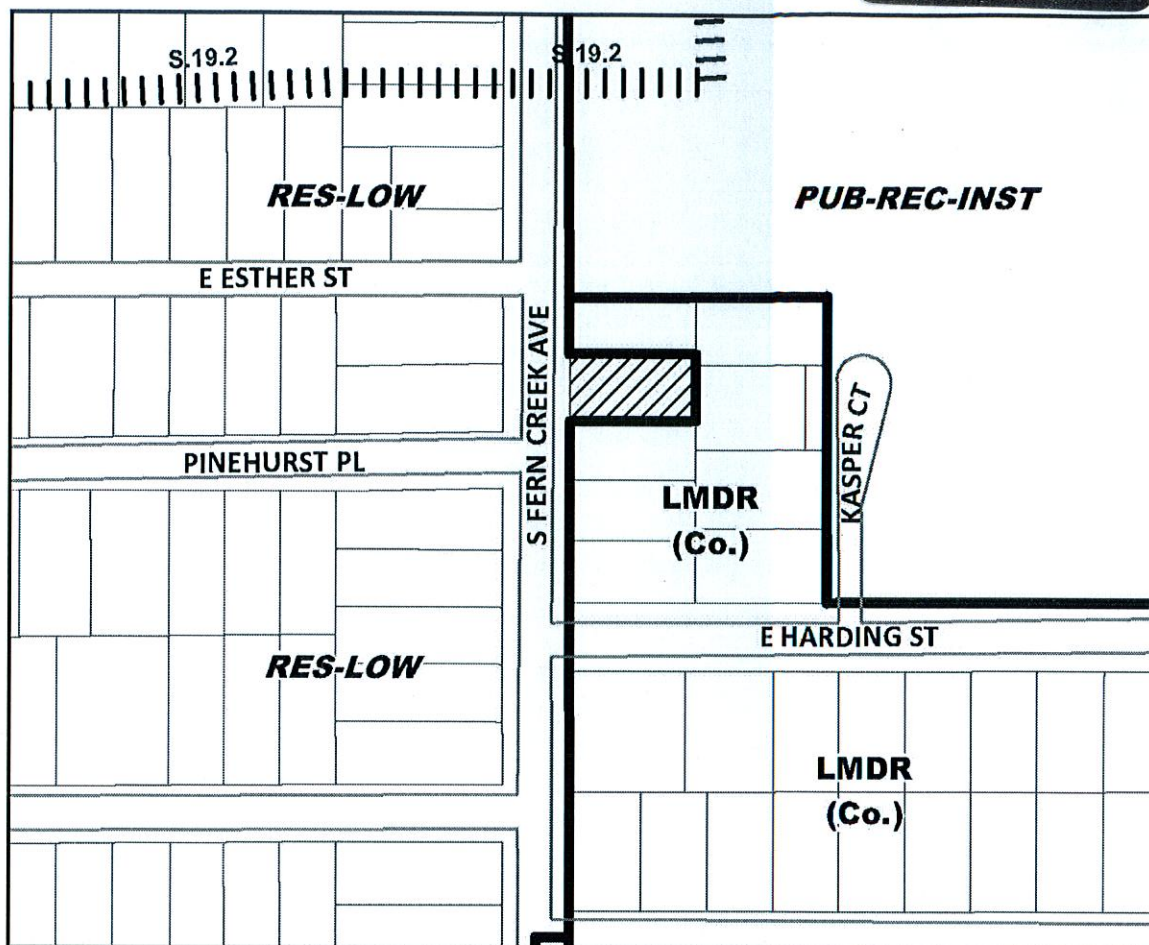

Future Land Use - Proposed GMP2015-00045



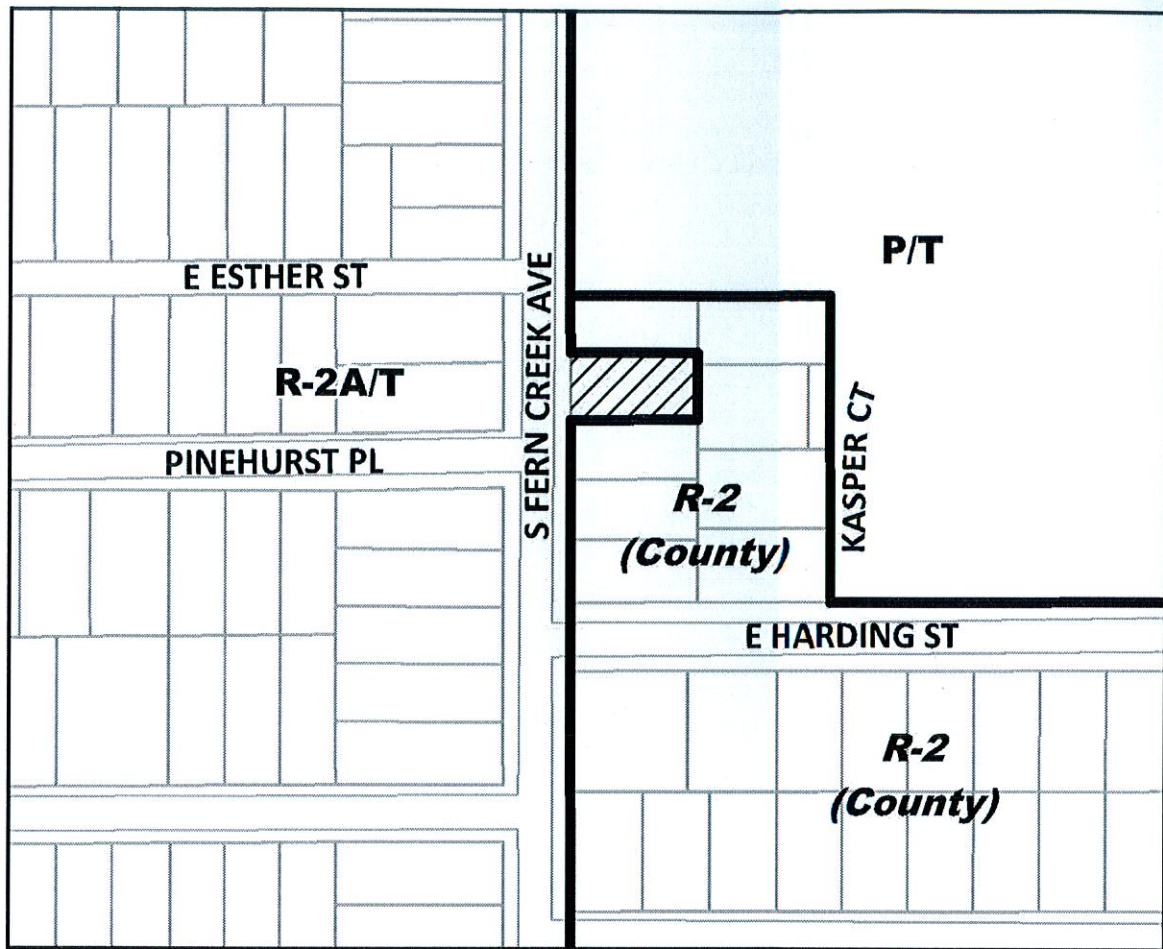

Zoning - Proposed ZON2015-00040

