

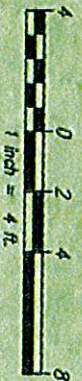

DW/LA
LANDSCAPE ARCHITECTURE



DELANEY PARK FLAGPOLE MEMORIAL

Illustrative Site Plan 2/27/2014

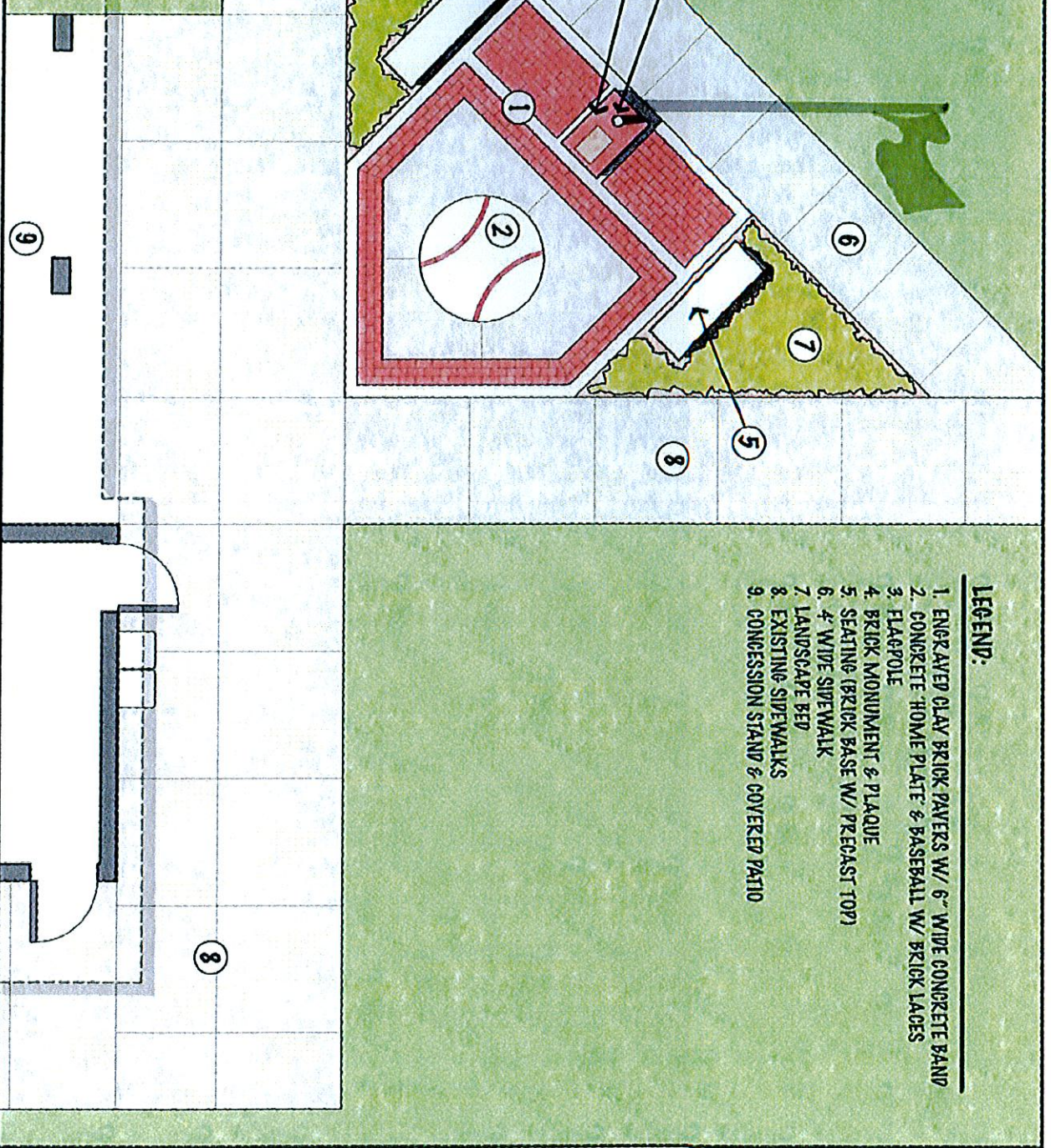

LEGEND:

- 1. ENGRAVED CLAY BRICK PAVERS W/ 6" WIDE CONCRETE BAND
- 2. CONCRETE HOME PLATE & BASEBALL W/ BRICK LACES
- 3. FLAGPOLE
- 4. BRICK MONUMENT & PLAQUE
- 5. SEATING (BRICK BASE W/ PRECAST TOP)
- 6. 4' WIDE SIDE WALK
- 7. LANDSCAPE BED
- 8. EXISTING SIDEWALKS
- 9. CONCESSION STAND & COVERED PATIO



DELANEY PARK
FLAGPOLE MEMORIAL

DIMENSION PLAN

2-27-2014

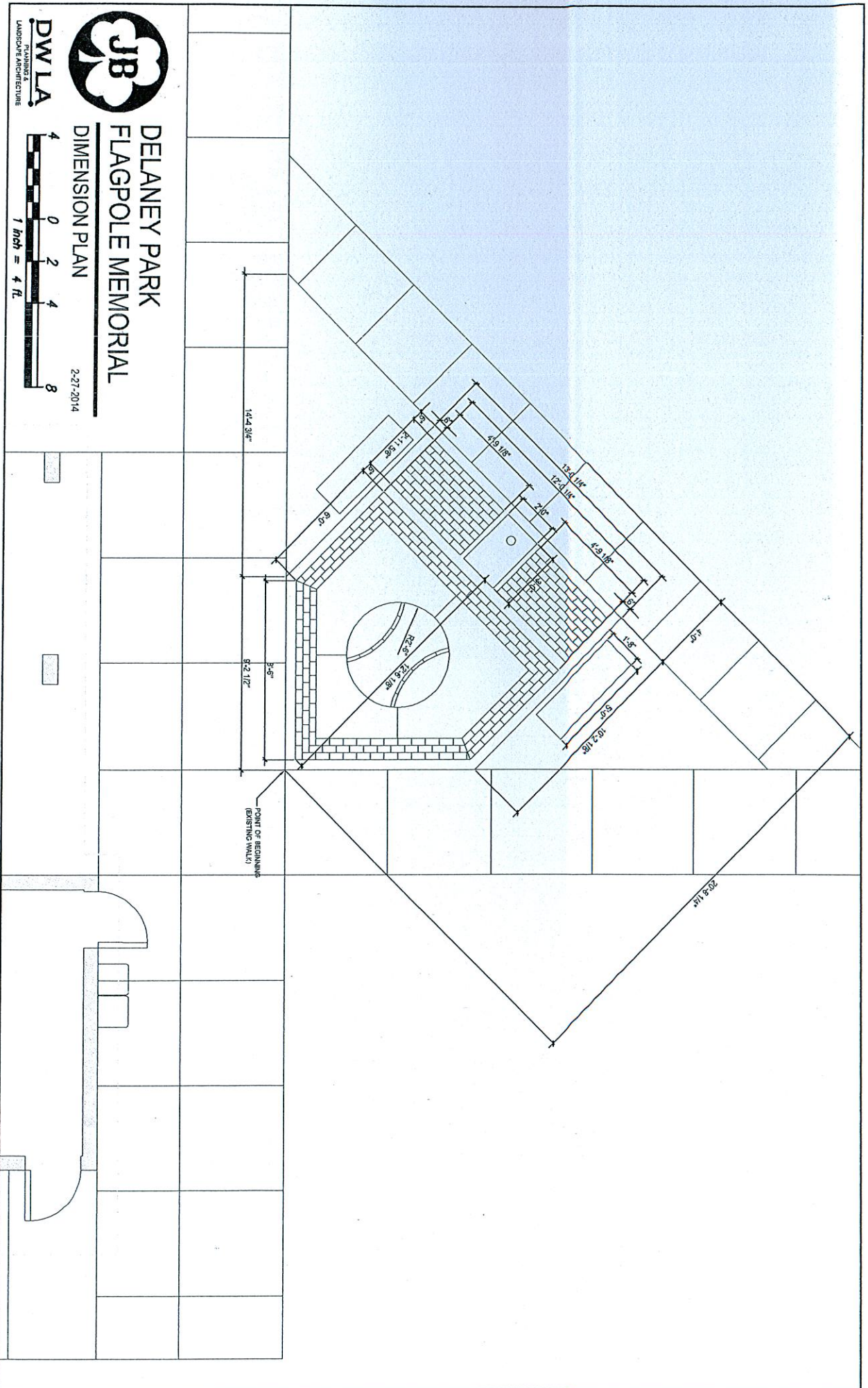



DELANEY PARK
FLAGPOLE MEMORIAL

SITE PLAN

2/27/2014

DW/LA

THOMPSON'S
LANDSCAPE ARCHITECTURE





Delaney Park Little League Flag Pole / Memorial Project

Delaney Park Little League Mission Statement:

To promote, develop, supervise, and voluntarily assist in all lawful ways, the interest of those who will participate in Little League Baseball and Softball while instilling **Character, Courage and Loyalty**.

Nature and Intent of Proposed Memorial or Monument:

To celebrate the 75th Anniversary of the National Little League, the 60th Anniversary of the Delaney Park Little League (DPLL) and to memorialize one of DPLL's greatest coaches, friend, father and husband, Jason Beaird, who lost his battle with cancer in 2013, the DPLL is proposing to build a flag pole / memorial capital improvement project (the Project/Exhibit A).

The DPLL at Delaney Park is home to three baseball fields; softball/rookie field, t-ball field and minors/majors field. Sixty years ago when the DPLL was founded at the opening of every game the Pledge of Allegiance was recited. Never having a true flag pole to say the Pledge to, over time, the practice was forgotten. The intent of this Project is to bring the Pledge back to every game while memorizing Jason Beaird (Coach Beaird). By saying the Pledge of Allegiance our players will be stating how proud they are to be an American. The DPLL believes that saying the pledge prior to every game assists in achieving our mission of Character, Courage and Loyalty.

Describe how the monument will memorialize a person, place, thing or event that is important to the City of Orlando's culture and/or history:

For the past 60 years the DPLL has been a vital part of Delaney Park and surrounding urban core neighborhoods in our service boundary. The DPLL provides a safe and fun learning environment for families. As one of the oldest and most established leagues in the City of Orlando, the DPLL provides a sense of community for boys and girls as they grow to adolescents, young adults, adults and eventually grandparents. The DPLL has over four generations of families that have played ball at our fields. The DPLL allows our downtown families to come together as a community and teaches our players the importance of team work, friendship, community.

The DPLL would like to dedicate the Project to Coach Beaird. Coach Beaird had a passion for baseball and was an essential part of the DPLL from 2008 until his passing on March 14, 2013 from cancer. Coach Beaird attended the University of Florida where he played baseball for the

Gators and was selected for the All SEC Academic Team. Coach Beaird carried his baseball expertise as a college player to the DPLL, St. James Cathedral School and the Catholic Youth League football and basketball teams. Some of his most cherished friends were fellow coaches and teammate parents. Coach Beaird epitomized the foundation of the DPLL organization. The DPLL was fortunate to have someone of Coach Beaird caliber as part of our organization. Coach Beaird was a lifelong Catholic and a parishioner of St. James Catholic Cathedral since moving to Orlando in 1993. Coach Beaird's wife and small children, Aaron and Shannon reside in Bel Aire and attend St. James Cathedral School. The DPLL looks forward to seeing his wife, Jennifer, and children continue his legacy.

Describe the monument, to include size and any specific design requirements (for large memorials please attach 8 copies and digital file of conceptual plan/drawing:

The proposed Project is located in the Delaney Park Master Plan. The DPLL has met with the Zoning Official related to this Project. After the meeting it was determined that the Project is a minor modification to the existing Master Plan. As a result, the DPLL is asking for an administrative approval of the Project through City Planning. Flag Poles in a residential district are a Conditional use that is why this process is necessary. The DPLL is running the City Planning and Parks processes concurrently.

The proposed location of the Project makes it visible from all three fields (Exhibit B). In addition, similar to the Delaney Park Neighborhood Association Fountain, the Project will be a wonderful addition to our park and neighborhood. The Project is in the shape of a baseball field home plate. Because the memorial is an odd shape please refer to the attached Exhibits C for the dimensions. The Project is visible from all three DPLL fields. The proposed location is currently passive with little to no use. The Project does not impede the pedestrian flow but improves it by providing more usable space, pedestrian areas and sidewalk connections.

The Project has the following elements (Exhibit D):

- Engraved clay brick pavers with 6 inch wide concrete band (pavers help to offset maintenance)
- Concrete home plate and baseball with brick laces
- 20 Foot Flagpole with the American Flag (specifications in Exhibit E, F and adheres to the Federal and State policies as stated United States Code Chapter 1 Title 4 "US Flag Code" and in the State of Florida Division of Administrative Services "Flag Protocol and Display requirement." The Flag will be illuminated at night by top down solar lighting. The DPLL is concerned that if we go with a line voltage ground up the light will be

vulnerable to the vandals (Exhibit G). The flag pole engineered documents which will include wind loads, etc. will be submitted at the time of permitting.

- Brick monument and memorial bronze plaque (Exhibit H).
- Seating (brick base w precast top)
- 4 foot wide sidewalk
- Landscape beds (grass and highly tolerant materials will be used)

Estimated cost and funding source* (design, construction, and installation)

Design: Donated

Construction: Estimated at \$12,000 funding for the project is the Delaney Park Little League via Jennifer Beaird and the Jason Beaird Memorial Fund.

Installation: Donated

Describe plan to maintain the memorial:

The DPLL currently has an existing Facility Use Agreement with the City of Orlando related to the maintenance and operation of the fields, concession etc. (Exhibit F). The DPLL proposes to enter into an Installation and Maintenance Agreement with the City of Orlando related to the Project. Maintenance costs will be paid for through brick sales similar to the Delaney Park Fountain. Each brick costs \$17 and are being sold for \$110. It is estimated that 15 bricks will need to be sold each year to maintain the memorial. The DPLL will cover the differential though our operating budget (Exhibit I).